

## Warnings:

- \* Risk of fire or electric shock.
- \* **Disconnect all power before installing or servicing.**
- \* Installation Instructions for qualified electricians only.
- \* Install per National Electrical Code and local regulations.
- \* Read Installation Instructions completely before installation.
- \* Failure to follow Installation Instructions may void warranties.

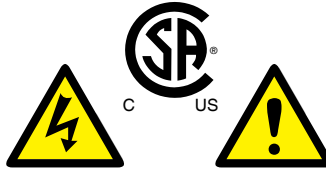

THIS PRODUCT MUST BE INSTALLED IN ACCORDANCE WITH THE APPLICABLE INSTALLATION CODE BY A PERSON FAMILIAR WITH THE CONSTRUCTION AND OPERATION OF THE PRODUCT AND THE HAZARDS INVOLVED.

### Pre-Installation Preparation

- \***Read Installation Instructions completely before installation.**
- \***Failure to follow Installation Instructions may void warranties.**

1. Screw Toggle Nut in place on 1/4 - 20 Screw using several turns. *See Fig 2.*
2. Make 3/4 inch diameter hole through Ceiling. *See Fig 2.*

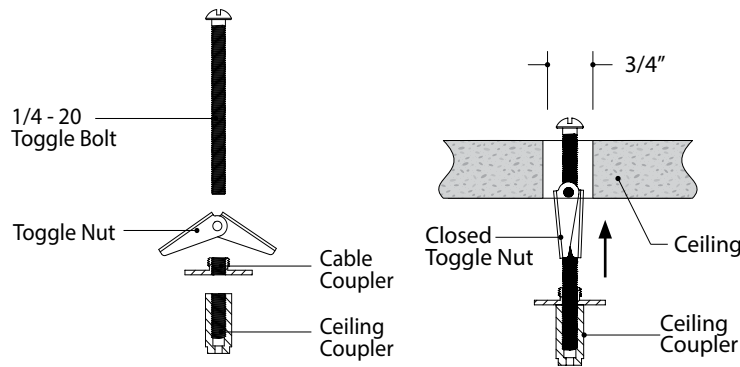

FIGURE 1

FIGURE 2

### HARDWARE MOUNTING:

1. Press Toggle Nut Closed and slide through 3/4 inch hole in Ceiling. *See Fig 2.*
2. With Toggle Nut Expanded tighten Cable Coupler until Ceiling stays tight between Toggle Nut and Cable Coupler. *See Fig 3.*
3. Screw Ceiling Coupler Cable Assembly onto screw. *See Fig 3.*

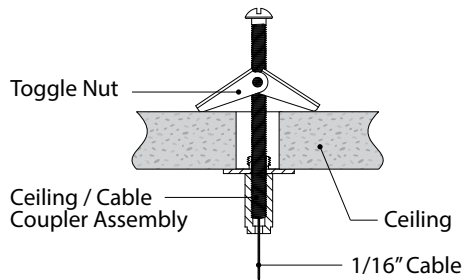

FIGURE 3

### FIXTURE MOUNTING:

1. Measure desired vertical height of ceiling to fixture.
2. Cut loose end of Cable to measured ceiling to fixture height.
3. Depress Griplock Glider Device Plunger and insert loose end of Cable into Griplock Glider Device.
4. Release Plunger to secure Cable and tighten plunger cap. *See Fig 4.*

### NOTE:

To shorten fixture height after installation, depress Plunger on Griplock Glider Device, remove Cable, cut Cable to new length and reinsert into Griplock Glider Device.

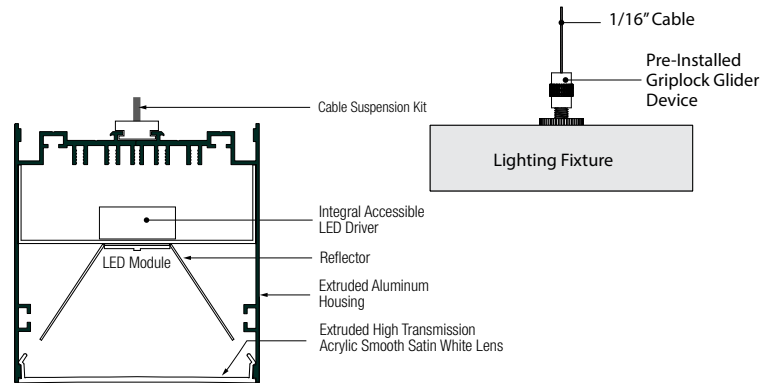

FIGURE 4

### ELECTRICAL CONNECTION:

J-box (octagonal box recommended, provided by others.)  
5" diameter steel canopy with power feed outlet and cable connector provided.

**DO NOT modify the factory wiring settings as it may cause the luminaire to malfunction. Provide electrical service, according to the "National Electrical Code" or your local electrical code, from a suitable junction box (octagonal junction box recommended).**

**Notes:** Review fixture labeling to make sure it is rated for the voltage installation being used. Supply wire insulation must be rated for at least 90° C.

**Make sure no bare wires are exposed and canopy, cable mounting is set securely in place.**