

PROJECT	TYPE	CATALOG NUMBER
---------	------	----------------

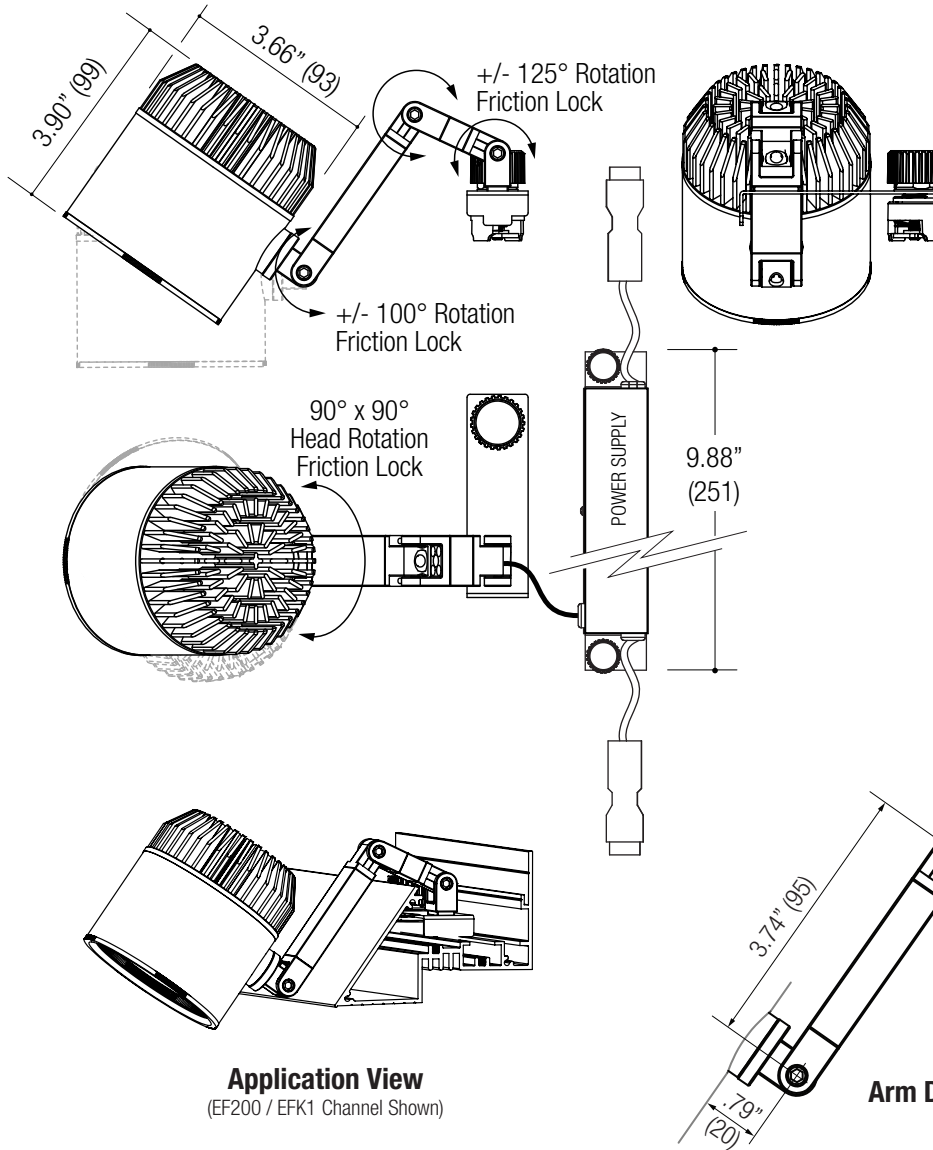

#### SPOTLIGHT

- 3.66" diameter cylinder
- 125° x 125° arm articulation - Friction lock
- 90° x 90° head rotation - Friction lock
- Die cast aluminum optical housing
- Articulating arm allows for greater aiming
- Powder coat finish

#### LED SOURCE - CREE

- Field-replaceable integral LED module
- Field-changeable optic
- Easy access via front ring snap-in catch action
- 19W / 1290lm (@ 80CRI / 3000K) Passive
- 26W / 2543lm (@ 80CRI / 3000K) Passive
- 34W / 3097lm (@ 80CRI / 3000K) Passive
- Accepts 1 or more optical accessories

#### ELECTRICAL

- Field-replaceable LED driver
- Dimmable

#### MOUNTING

- Fabricated steel extension arm
- Snap in, twist-lock mounting
- EF200 / EFK1 Single channel (*Sold Separately*)
- EF200 / EFK2 Dual channel (*Sold Separately*)

#### LABELS

- Suitable for damp location

**5 YEAR WARRANTY**  
Limited



#### ORDERING INFO

SERIES	WATTAGE	CRI / COLOR	BEAM	DRIVER	FINISH
<b>EF208C</b>	<b>19C</b> 19W LED 1290 lm delivered	<b>8027</b> 80CRI / 2700K	<b>N</b> Narrow 14° <b>M</b> Medium 24° <b>W</b> Wide 42°	<b>DMU</b> Dimming Multiple Forward/Reverse Phase (@ 120V only) 0-10V Wires Present (@ 120-277V)	<b>BB</b> Black <b>WW</b> White <b>XX</b> Custom
		<b>8030</b> 80CRI / 3000K			
<b>EF200</b> <b>Cylindrical Medium</b> Die Cast Aluminum Housing Variable Adjustment EFK1 & EFK2 Channel Mount	<b>26C</b> 26W LED 2543 lm delivered	<b>8035</b> 80CRI / 3500K			
		<b>8040</b> 80CRI / 4000K			
		<b>8050</b> 80CRI / 5000K			
		<b>9227</b> 92CRI / 2700K			
		<b>9230</b> 92CRI / 3000K			
		<b>9235</b> 92CRI / 3500K			
<b>9240</b> 92CRI / 4000K					
	<b>34C</b> 34W LED 3097 lm delivered  Delivered @ 80CRI / 3000K Medium Beam				

Ordering Example: **EF208C-26C-8030-N-DMU-BB**

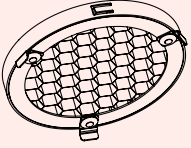
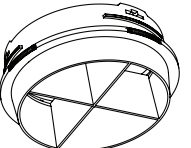
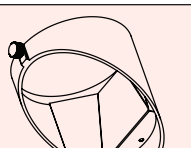
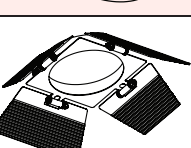
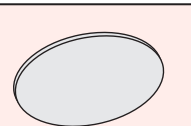
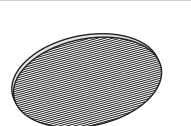
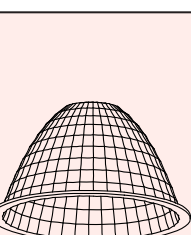
OPTICAL ACCESSORY	DESCRIPTION	LED SOURCE			
		EF208B / EF408B	EF208C / EF408C	EF208D / EF408D	
		<ul style="list-style-type: none"> <li>• 09W LED</li> <li>• 14W LED</li> <li>• 21W LED</li> <li>• 28W LED</li> </ul>	<ul style="list-style-type: none"> <li>• 28W LED</li> <li>• 35W LED</li> <li>• 41W LED</li> </ul>	<ul style="list-style-type: none"> <li>• 34W LED</li> <li>• 40W LED</li> <li>• 55W LED</li> </ul>	
	Hex Cell Louver - Black	OPT-EF208B-HXL	OPT-EF208C-HXL	OPT-EF208D-HXL	
	Snoot with Cross Baffle White	OPT-EF208B-CBWW	OPT-EF208C-CBWW	OPT-EF208D-CBWW	
	Snoot with Cross Baffle Black	OPT-EF208B-CBBB	OPT-EF208C-CBBB	OPT-EF208D-CBBB	
	Wallwash - White	OPT-EF208B-WWWW	OPT-EF208C-WWWW	OPT-EF208D-WWWW	
	Wallwash - Black	OPT-EF208B-WWBB	OPT-EF208C-WWBB	OPT-EF208D-WWBB	
	Barn Doors - White	OPT-EF208B-BDWW	OPT-EF208C-BDWW	OPT-EF208D-BDWW	
	Barn Doors - Black	OPT-EF208B-BDBB	OPT-EF208C-BDBB	OPT-EF208D-BDBB	
	Diffused Lens	OPT-EF208B-P-DFL	OPT-EF208C-P-DFL	OPT-EF208D-PDFL	
	Linear Spread Lens	OPT-EF208B-P-LSL	OPT-EF208C-P-LSL	OPT-EF208D-P-LSL	
	Reflector	Narrow Beam	OPT-EF208B-REFLN	OPT-EF208C-REFLN	OPT-EF208D-REFLN
		Medium Beam	OPT-EF208B-REFLM	OPT-EF208C-REFLM	OPT-EF208D-REFLM
		Wide Beam	OPT-EF208B-REFLW	OPT-EF208C-REFLW	OPT-EF208D-REFLW
		Very Wide Beam	OPT-EF208B-REFLV	N/A	OPT-EF208D-REFLV

PROJECT	TYPE	CATALOG NUMBER
---------	------	----------------

### ELECTRICAL COMPONENTS

**EFXFD**  
**POWER STARTER FEED**  
 Electrical Component

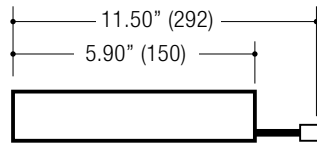

**Starter Box**

**EFXJW**  
**JUMPER WIRE**  
 Electrical Component

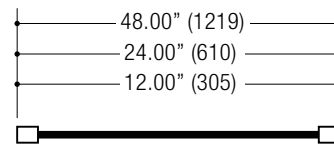

**Jumper Wire**

#### ORDERING INFO

SERIES	VOLTAGE	FINISH
<b>EFXFD</b> Power Starter Feed	<b>U</b> 5 Wire / 0-10V Capable	<b>BB</b> Black <b>WW</b> White

Ordering Example: **EFXFD-U-BB**

#### ORDERING INFO



SERIES	DESCRIPTION	VOLTAGE	FINISH
<b>EFXJW</b> Jumper Wire	<b>012</b> Jumper Wire 1' <b>024</b> Jumper Wire 2' <b>048</b> Jumper Wire 4'	<b>U</b> 5 Wire / 0-10V Capable	<b>BB</b> Black <b>WW</b> White

Ordering Example: **EFXJW-024-U-BB**

### TYPICAL COMPONENT INSTALLATION

